



THAME WORKHOLDING
 Field End, Thame Road
 Long Crendon, Aylesbury
 Bucks HP18 9EJ, England
 Tel: 01844 208050
 Email: sales@thameworkholding.com



Chuck Type:
KITAGAWA B 208

Fax: 01844 201699
 Web: www.thameworkholding.com

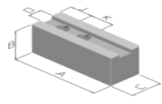

Type AS, AA

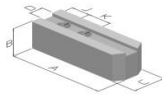

Type BS

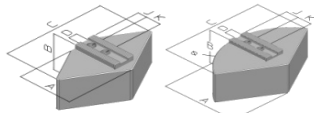

Type ES, EA

Type DS, DA

Serrated Soft Top Jaws 1.5x60°					Slot: 14mm	T-Nut to suit GP09	
Jaw Type	A	B	C	Kg/Set	Material	Part No.	
AS	90	35	35	2.2	080M15	BQ08	
AS	95	40	35	2.7	080M15	BO08	
AA	95	44	32	1.1	Aluminium	AA08	
BS	95	35	35	2.4	080M15	BA08	
AS	95	50	35	3.4	080M15	BB08	
AS	95	60	35	4.0	080M15	BC08	
AS	95	80	35	5.4	080M15	DJ08	
AA	95	76	32	1.9	Aluminium	AB08	
AA	95	102	32	2.5	Aluminium	AC08	
CS	85	40	35	2.2	080M15	CK08	
CS	95	40	35	2.9	080M15	CK09	
BS	102	40	35	2.9	080M15	PT08	

Full Wrap Top Jaws 1.5x60°							
Jaw Type	A	B	C	Kg/Set	Material	Part No.	
DS	89	64	150	14	080M15	CN20	
DA	76	64	150	5.0	Aluminium	HN20	
DA	76	100	150	7.8	Aluminium	HN21	
ES	99	76	210Ø	20	080M15	SG08	
EA	99	76	210Ø	9.8	Aluminium	AG08	

Adjustagrip Hard Jaws - External Clamping					T-Nut to suit GP09		
	B	C	b				
	49	40	20				
Gripping Ranges					590M17		
31-68mm						LB03	
60-96mm						LB06	
87-125mm						LB09	
114-152mm						LB12	

Adjustagrip Hard Jaws - Internal Clamping							
	B	C	b				
	49	40	20		590M17		
Gripping Ranges							
50-85mm						MB06	
78-115mm						MB08	
110-148mm						MB11	
139-178mm						MB14	

Adjustagrip Hard Bar Jaws						
	B	C	Grip Range			
	49	40	16-45mm	590M17	KK20	

Hard Reversible Top Jaws							
	A	B	C	S1	S2		
A	86	50	35	11	11	590M17	GT08

T-Nuts							
	D	H	b	K	Bolt		
	14	20.5	8.5	25	M12	817M40	GP09

Height Pins for Adjustagrips				
	H	WAF	Thread	
	5	10	M6	IT05
	10	10	M6	IT10
	15	10	M6	IT15
	20	10	M6	IT20

Quick Change Jaws						
	A	B	C	K		
Master	67.5	27.5	31.8	20	590M17	QK08
Standard	90	40	35		080M15	QS08
Tall	90	60	35		080M15	QT08
Pointed	105	40	35		080M15	QL08

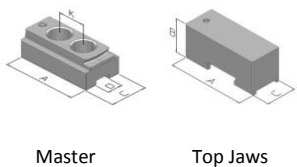

Master

Top Jaws

Thame Workholding also design and manufacture jaws to suit your specific workpieces.